



**MEMPHIS AND
SHELBY COUNTY** **DIVISION OF PLANNING
AND DEVELOPMENT**

City Hall – 125 N. Main Street, Suite 468 – Memphis, Tennessee 38103 – (901) 636-6619

**MEMPHIS LANDMARKS COMMISSION
CERTIFICATE OF APPROPRIATENESS**

TO: Denise Parker

ISSUE DATE: September 6, 2022

DOCKET: COA 2022-100

222 Stonewall Street

Evergreen HD

Sent via electronic mail to: parkeris@bellsouth.net

On September 2, 2022, the Memphis Landmarks Commission **approved** your application as a **MINOR COA** for Site Improvement to install a new wrought-iron gate at portico entrance, subject to the following conditions:

1. The new wrought-iron gate shall not exceed 8 feet in height.
 2. The new gate shall be located behind the front wall of the structure.
 3. Any change or deviation from the approved Certificate of Appropriateness (COA) shall be submitted to the Memphis Landmarks Commission for review and approval.
-

Be advised, this COA expires in one (1) year if a permit has not been issued by the Office of Construction Code Enforcement.

Respectfully,



Ayse Penzes

Municipal Planner

Land Use and Development Services

Division of Planning and Development

Encl: Approved gate details

Gate Details



MEMPHIS FENCE COMPANY, LLC
 1380 North Willett St, Memphis, TN 38108
 PH: 901-278-9710 FX: 901-278-9995
 Website: www.memphisfence.com
 "Serving the Mid South since 1971"

PROPOSAL FOR FENCE INSTALLATION

NAME Denise Parker DATE 8/4/2022
 ADDRESS 222 Stone Wall
 CITY Memphis STATE TN ZIP 38112
 PHONE 9014842167 CELL _____ WK NO _____
 EMAIL Parkeris@bellsouth.net FAX NO _____

PERMIT REQUIRED Yes No Homeowner to obtain permit Permit obtained by contractor

WOOD	CHAINLINK	VINYL	ORNAMENTAL
TOTAL FOOTAGE _____	TOTAL FOOTAGE _____	TOTAL FOOTAGE _____	TOTAL FOOTAGE _____
HEIGHT _____	HEIGHT _____	HEIGHT <u>7'</u>	HEIGHT <u>7'</u>
STYLE _____	<input type="checkbox"/> GALVANIZED <input type="checkbox"/> VINYL COATED	STYLE _____	<input type="checkbox"/> ALUMINUM <input checked="" type="checkbox"/> STEEL
BOARDS _____	GAUGE _____	REF NO _____	<input type="checkbox"/> SPECIAL ORDER <u>3 post</u>
<input type="checkbox"/> CAP <input type="checkbox"/> TRIM <input type="checkbox"/> BATTON	FRAME _____	<input type="checkbox"/> 2-RAIL <input type="checkbox"/> 3-RAIL <input type="checkbox"/> 4-RAIL	COLOR <u>Black</u>
RAIL <input type="checkbox"/> 1 <input type="checkbox"/> 2 <input type="checkbox"/> 3 <input type="checkbox"/> 4	TERMINAL POSTS _____	COLOR _____	FINALS <u>Spear</u>
<input type="checkbox"/> CEDAR <input type="checkbox"/> #2 PRIME PINE	LINE POSTS _____	CAP _____	PICKETS <u>3/4 x 3/4</u>
POST _____	TOP RAIL _____	GATE(S) _____	RUNNERS <u>2x1 channel</u>
<input type="checkbox"/> #1 CENTERCUT PINE	GATE(S) _____	SINGLE _____	LINE POSTS <u>2 1/2 x 2 1/2</u>
GATE _____	DOUBLE _____	DOUBLE _____	GATE(S) _____
<input type="checkbox"/> 4x4 <input type="checkbox"/> 6x6 <input type="checkbox"/> STEEL	GATE POSTS _____	SPECIAL ORDER _____	SINGLE <u>4' / 13' automated</u>
GATE _____			DOUBLE _____
<input type="checkbox"/> 4x4 <input type="checkbox"/> 6x6 <input type="checkbox"/> STEEL			GATE POSTS _____

CONSTRUCTION NOTES:
 NOTE: PRICE BREAKDOWN BASED ON LINE
 OF INDIVIDUAL PROJECTS.

FENCE INSTALLATION RELATED TO GRADE: PLEASE INITIAL ONE

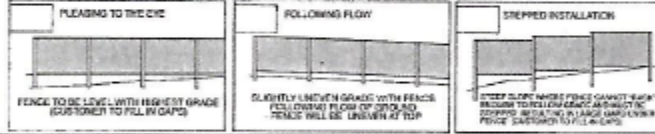

FENCE DIAGRAM

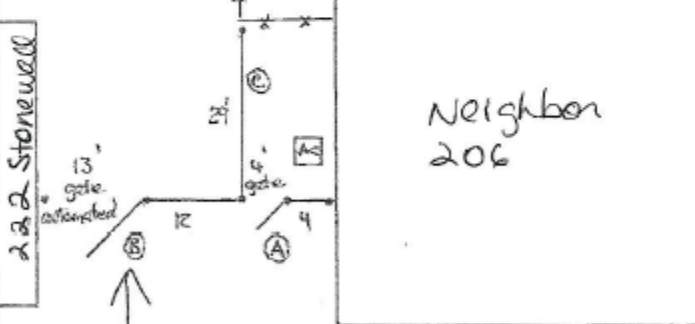

B only for the COA

A+C have already been approved under Neighbor @ 206

Stone wall

	<input type="checkbox"/> Fence To Be Removed	<input type="checkbox"/> Disposal Included	<input type="checkbox"/> Post Set In Concrete
		Option 1: Fence and gates	Option 2: Automation
TOTAL INSTALLATION COST	\$6,820.00	\$3,210.00	\$2557.00
DEPOSIT AMOUNT	\$3,410.00	\$1,605.00	\$1,278.50
BALANCE DUE (UPON COMPLETION)	\$3,410.00	\$1,605.00	\$1,278.50

DISTRIBUTION: White - Office Copy Yellow - Customer Copy

